

1. 23721 Lipseal Cassette C200

- A. Remove sliding cover and 2 screw covers.

Note: Lever off gently screw covers located on either side of the seal cover.



- B. Unscrew the 8 screws on the seal cover and, take the seal cover off.



- C. Place new lipseal on the waste tank. **Note:** Thinner flange has to face downwards towards the blade.



- D. Screw seal cover back onto the waste tank and press both screw covers back on the seal cover.

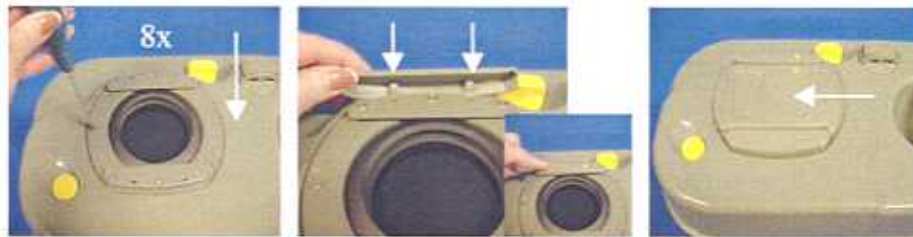

1. 23721 Lipseal Cassette C2/C3/C4 (Toilets produced after 15 June 2000)

- A. Remove the sliding cover and unscrew the 8 screws on the seal cover.



- B. Place new lipseal on the waste tank. **Note:** Thinner flange has to face downwards towards the blade.



- C. Screw seal cover back onto the waste tank.

